



**Part Number:**

1260000

**Size:**

49.25 OD x 59.92 Long

Tank Type: PMD	Mount Style: Tabs	Location: Girth	PMD Device:
-------------------	----------------------	--------------------	-------------

Dual tank design for propellant and oxidizer.

Applicable Documents	Tank Characteristics:	Tank Characteristics (Metric):		
Interface Control Doc. 1260000_ICD	Total Volume, in <sup>3</sup> :	77,805	Total Volume, L:	1275
	Propellant Volume, in <sup>3</sup> :		Propellant Volume, L:	
	Max Design Weight, lbs:	97.3	Max Design Weight, kg:	44.13
	Minimum Wall Thickness, in:		Minimum Wall Thickness, mm:	
	Operating Pressure, psia:	300	Operating Pressure, bar:	20.68
	Proof Pressure, psia:	375	Proof Pressure, bar:	25.86
	Cryo Proof, psia:	N/A	Cryo Proof, bar:	N/A
	Burst Pressure, psia:	450	Burst Pressure, bar:	31.03
Notes:	Tube Type:	Size:		
Tanks similar in all aspects but inlet tube orientation.				

**Applications Testing:**

**Qualifications Testing:**

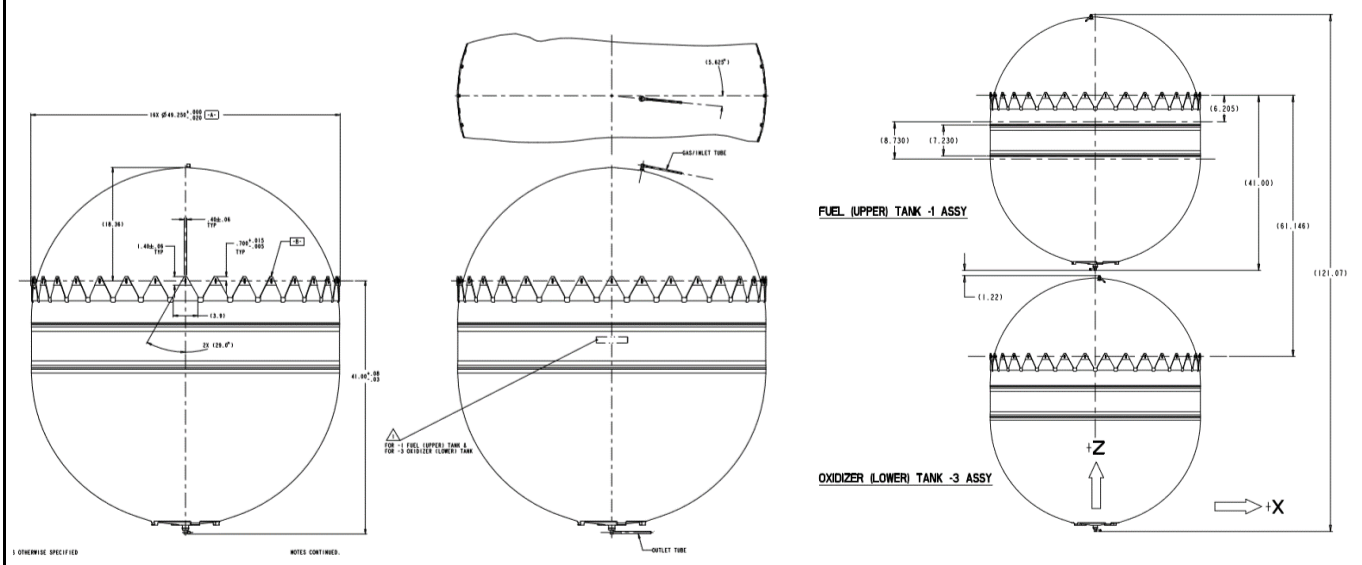

11/15/2017

4401 Donald Douglas Dr.  
Long Beach, CA 90808

Telephone: 562-497-3200